

Pos. Nr. Pos.no.	Beschreibung Description	Art.-Nr. Art.no.	Preisgruppe Price bracket															
<table border="1" style="width:100%; border-collapse: collapse;"> <tr> <td style="width:15%;">52623</td> <td style="width:15%;">SNCB</td> <td style="width:15%;">Reeks 54</td> <td style="width:15%; text-align:center;">=</td> <td style="width:40%;"></td> </tr> <tr> <td>52624</td> <td></td> <td></td> <td style="text-align:center;">=</td> <td style="text-align:center;">🔊</td> </tr> <tr> <td>58624</td> <td></td> <td></td> <td style="text-align:center;">~</td> <td style="text-align:center;">🔊</td> </tr> </table>				52623	SNCB	Reeks 54	=		52624			=	🔊	58624			~	🔊
52623	SNCB	Reeks 54	=															
52624			=	🔊														
58624			~	🔊														
1	Motor mit 2Schwungm.,Kardanschale Motor w.2flywheels,cardan reception	85112	28															
2	Zugfeder Draw spring	86208	3															
3	Platine kpl. Printed circuit board assembly	127562	19															
4	Brückenstecker Connector	100644	6															
5	Drahtlampe T1 16V/30mA Bulb with leads T1 16V/30mA	109321	8															
6	Lampenhalter Lamp holder	109879	3															
7	Grundrahmen Basic frame	131872	16															
8	Lampen-Flexplatine Flexible light pcb	113691	14															
9	Puffer eckig gewölbt Rectangular buffer curved	113841	3															
10	Puffer eckig flach Rectangular buffer flat	113842	3															
11	GF-Schraube M1,6x6 mm Self-tapping screw M1,6x6 mm	114836	3															
12	GF-Schraube M2x5 mm Self-tapping screw M2x5 mm	114966	3															
13	Gehäuse komplett Betr.Nr. 5403 Body completely loco.no. 5403	140432	29															
14	TS-Gehäuse Part set body	120111	12															
15	TS-Fenster und Lichtleiter Part set window and light conductor	140433	13															
16	Kardanschale kurz 1,5 mm Cardan reception short 1,5mm	87129	4															
17	TS-Gehäuse lackiert Part set body painted	140441	6															
18	TS-Griffstangen Part set handles	131876	6															
19	Scheibenwischer links und rechts Windshield wiper left and right	113701	6															
Sound																		
20	Lautsprechergehäuse Loudspeaker body	114062	3															
21	Lautsprecher Haltebügel Loudspeaker holder	131214	5															
22	Lautsprecher Loudspeaker	129524	16															
23	Sounddecoder Sound-decoder	129600	39															

Änderungen in Konstruktion und Ausführung vorbehalten
We reserve the right to change the construction and specification

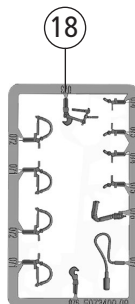
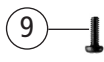
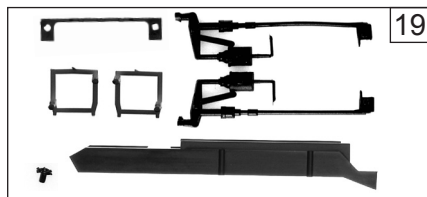
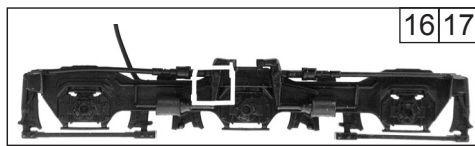
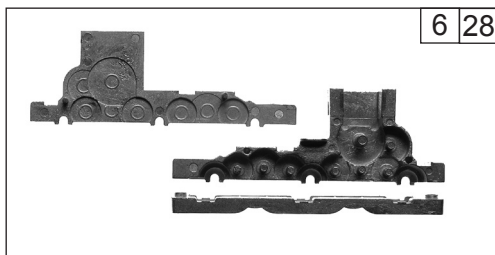
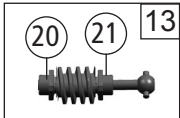
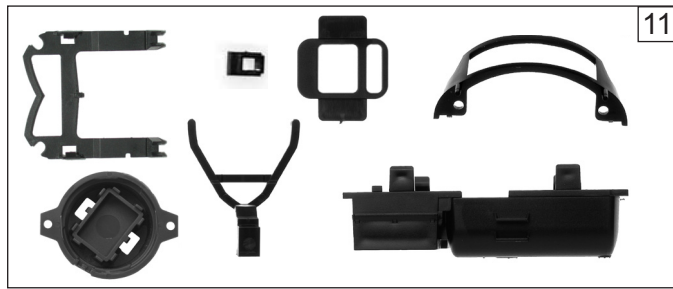

Pos. Nr. Pos.no.	Beschreibung Description	Art.-Nr. Art.no.	Preisgruppe Price bracket
52623	SNCB Reeks 54		
52624			
58624			
1	Hafringsatz 10Stk. 10,3-12,8mm Set with traction tyres 10,3-12,8mm	40069	---
2	Zahnrad Z=17/M=0.4 mm G Gear wheel Z=17/M=0.4 mm G	86418	5
3	Schneckenzahnrad doppelt Z=16/17 Double worm gear wheel Z=16/17	86419	6
4	Zwischenzahnrad Z=14 Intermediate gear wheel Z=14	86480	3
5	Standardkupplung Standard coupling	89246	6
6	Getriebesatz 3-teilig Gear set 3-parts	113692	13
7	Schneckendeckel Worm gear cover	113724	5
8	GF-Schraube M2x6 mm Self-tapping screw M2x6 mm	114828	3
9	GF-Schraube M1,6x6 mm Self-tapping screw M1,6x6 mm	114836	3
10	Radkontakt D=1,3 mm Wheel contact D=1,3 mm	114849	3
11	TS-Unterboden bedruckt Set of parts for lower floorplate printed	120105	12
12	Kardanwelle Cardan shaft	105906	4
13	Schneckensatz mit Kardankugel Set of worm gear incl. cardan ball	113705	13
14	Radsatz m. Zahnrad o. Hafring Wheelset w.gear wheel w/o traction tyres	120109	11
15	Radsatz m. Zahnrad m.2 Hafringen Wheelset w.gear wheel w.2 traction tyres	120110	12
16	Blende 1/3 komplett Bogie 1/3 complete	120113	13
17	Blende 2/4 komplett Bogie 2/4 complete	120114	13
18	TS-Bremsschläuche und Zughaken Part set of brake tubes & coupling hooks	139832	7
19	TS-Drehgestell Part set bogie	120116	10
20	Lager für Schneckenachse Bearing for worm gear axle	89749	6
21	Anlaufscheibe Washer	114622	3
22	Schienenräumer offen and Vitrine Set of railguards w.opening and for showcase	114003	6
AC-Wechselstrom			
23	Hafringsatz 10Stk. 10,3-12,4mm Set with traction tyres 10,3-12,4mm	40074	---
24	Schleifer 42mm Center pick-up 42 mm	86030	14
25	Radsatz m. Zahnrad o. Hafring AC Wheelset w.gear wheel w/o traction tyres AC	120119	11
26	Radsatz m. Zahnrad m.2 Hafringen AC Wheelset w.gear wheel w.2 traction tyres AC	120120	12
27	Radsatz ohne Zahnrad ohne Hafring AC Wheelset w/o gear wheel w/o tract. tyre AC	120121	10
28	Getriebesatz 3-teilig AC Gear set 3-parts AC	120122	12